

WALL2WALL

Installation Instructions

**PLEASE READ ALL INSTRUCTIONS
BEFORE INSTALLATION**



INCLUDED HARDWARE

- L-Channel (**Fig. A**)
Used to support the bottom horizontal edge of your Wall2Wall glass.
- T-Trim (**Fig. B**)
Used to provide consistency in vertical spacing for the application of multiple Wall2Wall glass panels, if applicable.

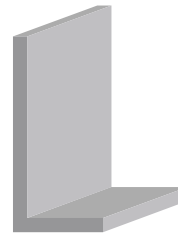

Fig. A L-Channel

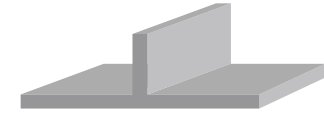

Fig. B T-Trim

SUGGESTED ADHESIVES & TAPES

The following adhesives and tapes have been recommended by installers to best install this product:

- Loctite® PL Premium FAST GRAB Polyurethane Construction Adhesive (**Fig. C**)
- Extreme E6000 Polyether Moisture Cure Premium Adhesive & Sealant (**Fig. D**)
- 3M™ VHB™ Structural Glazing Tape (**Fig. E**)



Fig. C



Fig. D



Fig. E

Disclaimer

The information and recommendations contained herein are based on our research and are believed to be accurate, but no warranty, express or implied, is made or should be inferred. Purchasers should test the products to determine acceptable quality and suitability for their own intended use.

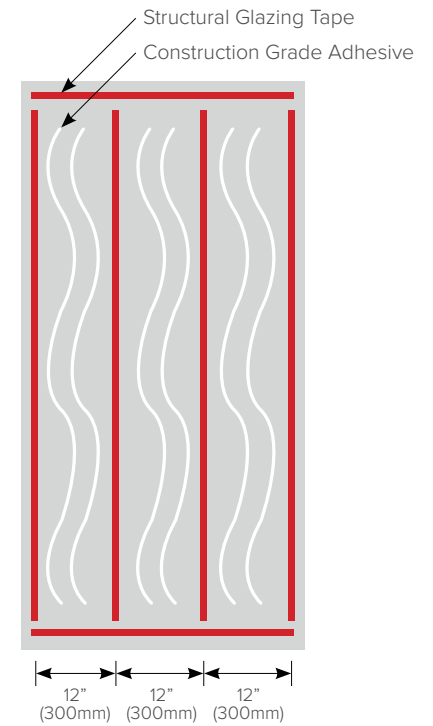
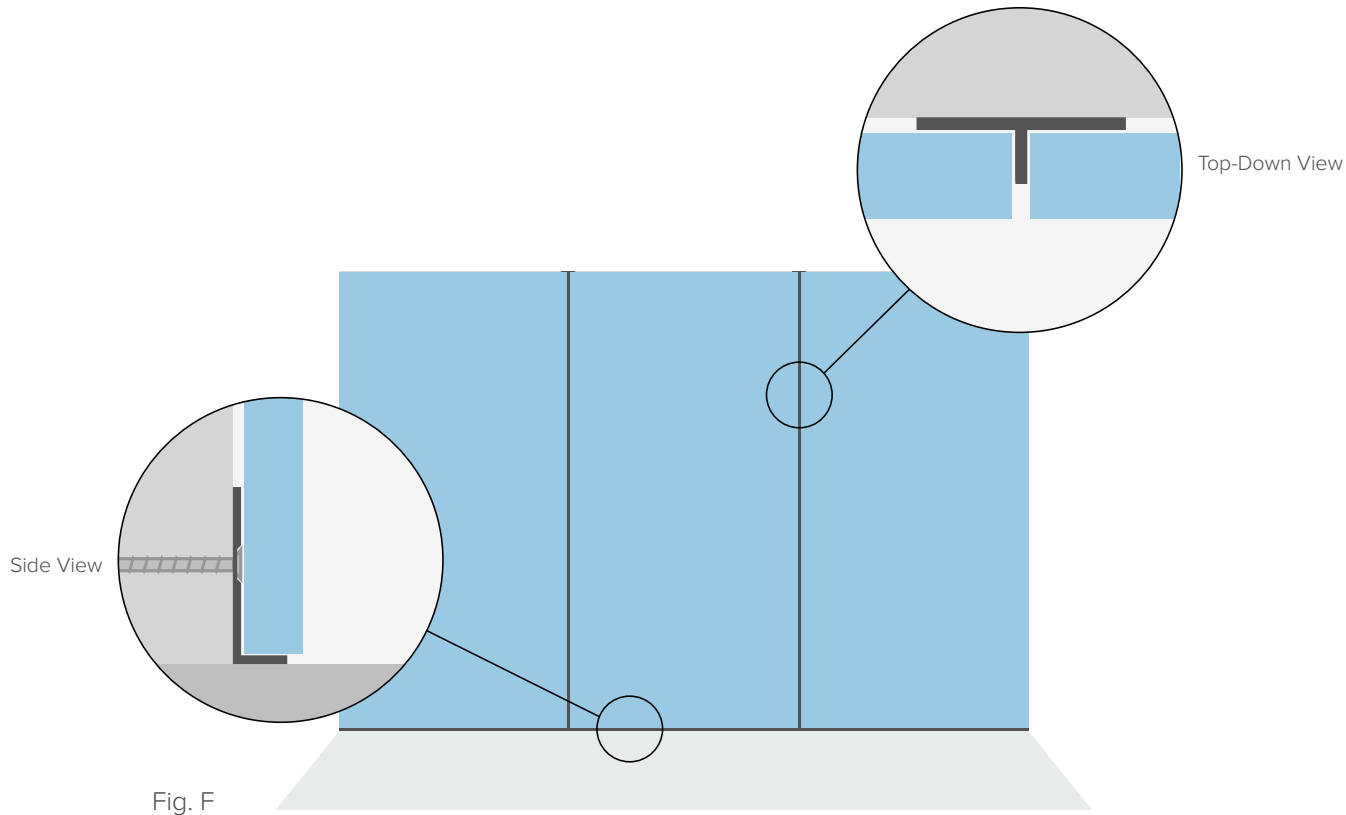

STEP 1

Apply L-Channel to wall to ensure panels will be level (**Fig. F**).

STEP 3

Apply construction grade adhesive in a consistent pattern to the back of each glass panel (**Fig. G**), ensuring adhesive will not bleed out from behind the panel.

STEP 5

Slide T-Trim under the edge of the panel (**Fig. F**), so the adjoining panel will be properly spaced if adjoining multiple panels.

STEP 7

Repeat this process until all panels have been installed.

STEP 2

Apply structural glazing tape (**Fig. G**) to perimeter of glass and in 12" (300mm) columns for support during curing phase of adhesive.

STEP 4

Peel backer from glazing tape and place glass onto drywall.

STEP 6

Additional bracing from the face of the glass is recommended during the curing phase of the adhesive.